

# POE

Architects & Engineers

## Contact us:

### Address:

Al Fattan Plaza Building, Al Garhoud  
Office No. 711 - 712, 7<sup>th</sup> floor,  
P.O. Box: 97046, Dubai, United Arab Emirates

**Tel.:** +971 4 283 2283,

**Fax:** +971 4 282 8990

**E-mail:** [info@poeconsultants.com](mailto:info@poeconsultants.com)

[www.poeconsultants.com](http://www.poeconsultants.com)





# INDEX

- 1 Introduction
- 2 About Us
- 3 Services
- 4 Buildings
- 12 Accommodations
- 16 Other Buildings
- 20 Master Plans
- 24 Villas
- 30 Mosques
- 34 Industrial Buildings
- 38 Bus Depots
- 42 Certificates
- 44 Our Clients

# INTRODUCTION

ARCHITECTURAL • CIVIL • MECHANICAL • ELECTRICAL PLUMBING  
 DESIGN & CONSTRUCTION PROGRESS SUPERVISION • MARINE WORKS



**Pioneers of Experts Engineering Consultants (POE)** is one of the leading design firms in the UAE providing Architectural, Civil, Mechanical, Electrical, Plumbing, Design and Construction progress supervision. POE firmly believes that design solutions must fit to the time, place and culture in which they are located. Guided by the principle, the company utilizes its vast resources and experience in building long-term partnerships with its customers by offering them with a full range of construction services, reflecting outstanding architectural and engineering solutions.

# ABOUT US

Since the beginning of its establishment on May 16, 2000 in Dubai, Pioneers of Experts Engineering Consultants (POE) consistently creates innovative and outstanding design solutions that revolutionize the way people live and work.

POE is one of the leading design firms in the UAE providing architectural, civil, mechanical, electrical, plumbing, design and construction progress supervision. We firmly believe that design solutions must fit to the time, place and culture in which they are located. Guided by the principal, the company utilizes its vast resources, experience in building long-term partnership with its customers and offers them with a full range of construction services, reflecting outstanding architectural and engineering solutions.

# CERTIFICATIONS

- ISO certified in the Quality Management Systems (QMS) 9001:2015;
- Environmental management systems (EMS) 14001:2015;
- Occupational Health & Safety Management Systems (OHSAS) 18001:2007;
- Qualifying for ISO 45001:2018;

# OUR MISSION

- We are committed to our clients by providing the high quality, ecofriendly, cost-effective design, supervision services;
- Satisfy our customers need & expectations with the solution to meet all commitments on time;
- Deliver state of modern technology in our services;
- Meet all commitments to customers on time;
- Verify our services to meet the agreed requirements;
- Monitor, bench mark & continually improve our business, design products, services of our organization & employees performance;

# OUR VISION

- To be recognized as a leading expert in design, supervision and as well as in the fields of interior design, infrastructure works , green building consultancy by maximizing use of green know how;
- Strengthening our leadership through combined solid team work with gained reputation of reliability and quality in the industry.
- Maintaining retaining quality & safety assurance in pursuit of services excellence.



# SERVICES

We always exert premium efforts on maintaining quality, safety, and health and environment protection while providing our services. Our community of highly skilled designers and supervision engineers work seamlessly alongside structural civil engineers and environmental experts to ensure quality design solutions following best international standards. With our proven track record in the construction industry, we have extended our activities in the field of Marines works. Full list of activities are below:

## Sectors of Expertise

- Building design and supervision
- Master planning
- Architectural, structural and MEP designs
- Project management
- Contracts and claim management
- Cost control and planning
- Feasibility study
- Quantity surveying
- Authority approvals

## Buildings

- **Residential Buildings**
  - High rise buildings
  - Medium rise buildings
  - Hotels
  - Accommodations: (Staff / Labor / Students)

- **Commercial Buildings**
  - Offices
  - Hospitals
  - Clinics
  - Shoppings centers
  - Schools

- **Industrial Buildings**
  - Warehouses
  - Factories
  - Showrooms

- **Villas / Group of Villas**

- **Mosques**

- **Sports & Leisure**

- **Media**

- **Bus Depots**

- **Solar Power Plants**



# BUILDINGS

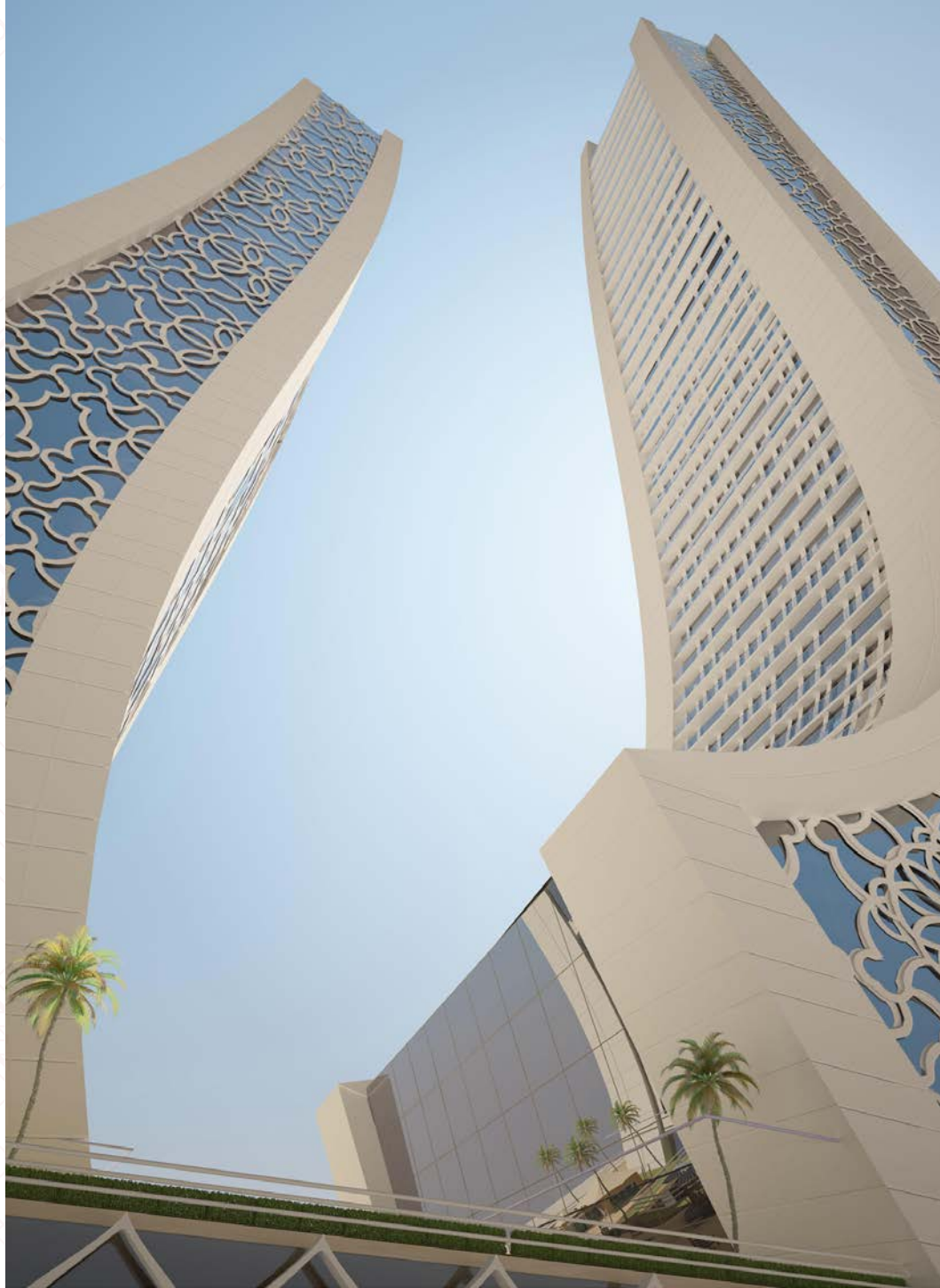



# High-rise buildings



**Continental Tower**  
Residential Commercial  
4B+G+29+R  
Dubai Marina  
Design + Supervision  
BUA: 497,957 Sq.ft



**AKA Residence**  
Residential Commercial  
Jumeirah Village Circle, Dubai  
B+G+4P+21+R  
Design + Supervision  
BUA: 360,727 Sq.ft



**Residential Commercial Building**  
G+70  
Sheikh Zayed Road, Dubai  
Design Proposal  
BUA: 1,388,565 Sq.ft



**Hotel Apartment Tower**  
Residential Commercial  
G+6P+38+R  
Al Nahda, Sharjah  
Design + Supervision  
BUA: 384,582 Sq.ft



Mid-rise buildings

Tiger 3 – Mizin

Residential Commercial  
G+14+R  
Al Jadaf, Dubai  
AOR + Supervision  
BUA: 234,526 Sq.ft



Al-Fajr Building

Residential Commercial  
3B+G+M+5+R  
Oud Metha, Dubai  
Design + Supervision  
BUA: 663,604 Sq.ft



Residential Commercial Building

1B+G+8+R  
Dubai Silicon Oasis, Dubai  
Design + Supervision  
BUA: 207,684 Sq.ft

Residential Building

G+6+R  
Al Warqa First, Dubai  
Design + Supervision  
BUA: 111,887 Sq.ft





Mid-rise buildings



▲ **AKA Residence**  
Residential Commercial  
B+G+4+R  
Jumeirah Village Circle, Dubai  
Design + Supervision  
BUA: 133,082 Sq.ft



◀ **Tiger 1 – Mizin**  
Hotel Apartments  
2B+G+15+R  
Wadi Al Safa 3, Dubai  
AOR + Supervision  
BUA: 355,929 Sq.ft



**DEWA Research  
& Development Center  
+ Laboratory**  
G+1  
Saih Al dahal, Dubai  
AOR + Supervision  
BUA: 47,841 Sq.ft



▶ **Tiger 2 – Mizin**  
Hotel Apartments  
2B+G+20+R  
Wadi Al Safa 3, Dubai  
AOR + Supervision  
BUA: 313,121 Sq.ft



# ACCOMMODATIONS







◀ **Student Accommodation**  
**DIAC Homes**  
6 Nos. B+G+5  
Residential Commercial  
Al Rowaiyah First, Dubai  
Design + Supervision  
BUA: 995,382 Sq.ft

▼ **Labor Accommodation**  
G+3+R  
Jabel Ali Industrial Area  
Design + Supervision  
BUA: 83,707 Sq.ft



**MCAG Residence**  
Labor Accommodation  
G+4+R  
Jabel Ali Industrial Area  
Design + Supervision  
BUA: 145,470 Sq.ft





# OTHER BUILDINGS





# Hospitals



Mediclinic Parkview Hospital  
2B+G+8+R  
Al Barsha South Third, Dubai  
AOR + Supervision  
BUA: 632,048 Sq.ft

Al Garhoud Private Hospital  
2B+G+M+3+R  
Al Garhoud, Dubai  
Design + Supervision  
BUA: 133,437 Sq.ft



# Shopping centers



Union Co-op Shopping Center  
Commercial Building  
B+G+1  
Dubai Silicon Oasis, Dubai  
Design Proposal  
BUA: 202,677 Sq.ft

Union Co-op Shopping Center  
Commercial Building  
B+G+2+R  
Al Salamah, Umm Al Quwain  
Design Proposal  
BUA: 229,595 Sq.ft





# MASTER PLANS





# Staff village, Dubai logistics city, Dubai South.

**Dubai Logistics City**  
 Staff Village - Dubai South  
 Staff Accommodation  
 G+4+R  
 Design Proposal



# Staff village, Residential city, Dubai South.

**Dubai Residential City**  
 Staff Village - Dubai South  
 Staff Accommodation  
 Phase one – 10 Nos. G+4+R  
 Design + Supervision  
 BUA: 641,620 Sq.ft



# VILLAS





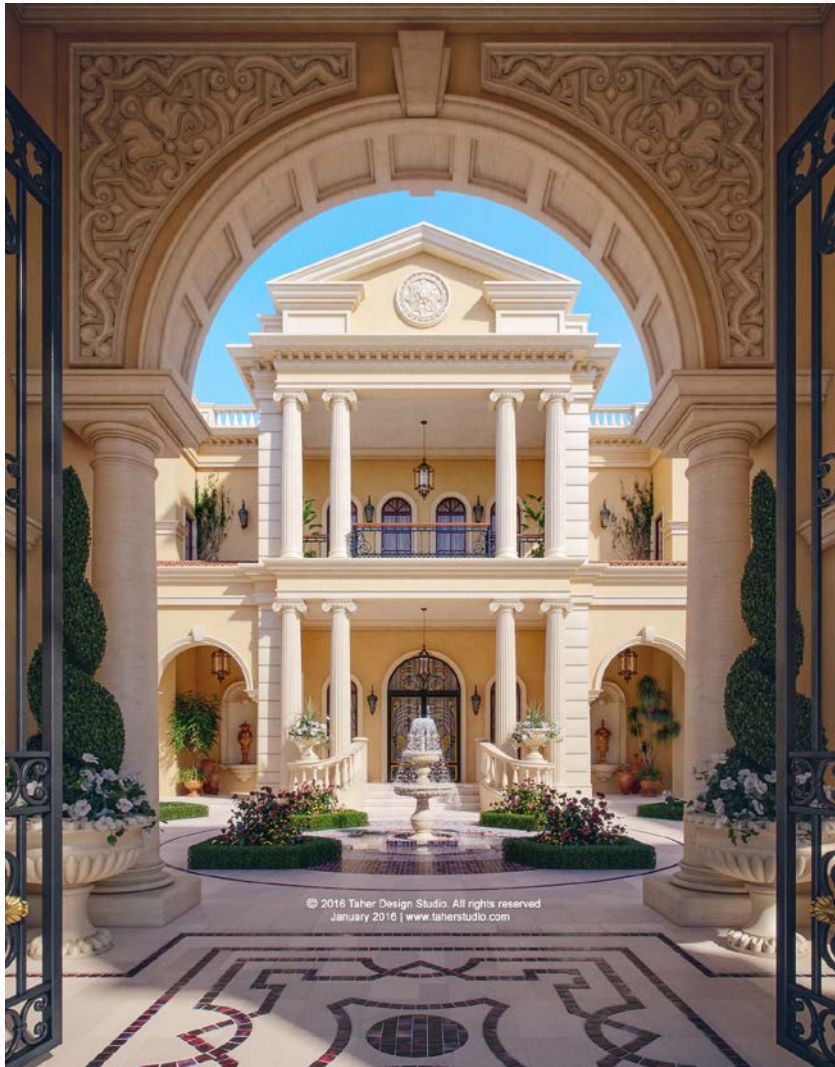

◀ **Private Residential Villa**  
B+G+1  
Nad Al Shiba, Dubai  
Design + Supervision  
BUA: 34,974 Sq.ft



◀ **Private Residential Villa**  
B+G+1  
Al Mizhar First, Dubai  
Design + Supervision  
BUA: 16,209 Sq.ft

**Private Residential Villa**  
B+G+1  
Dubai Land  
Design + Supervision  
BUA: 9,073 Sq.ft ▶



◀ **Private Residential Villa**  
G+1  
Margham, Dubai  
Design + Supervision  
BUA: 12,554 Sq.ft





230 Nos.  
**Private Residential Villa**  
B+G+1  
Saih Shuaib First, Dubai  
Design + Supervision  
BUA: 1,194,384 Sq.ft



▲ **Westar Properties**  
Group Private Villas 23 Nos.  
B+G+2  
Jumeirah Village Circle, Dubai  
Design + Supervision  
BUA: 76,085 Sq.ft

▼ **Dubai Air wings**  
71 Nos. of Villas  
B+G+1  
Al Garhoud, Dubai  
Design + Supervision





# MOSQUES







▲ **Texture holdings Mosque**  
G+M  
Al Quoz Fourth, Dubai  
Design + Supervision  
BUA: 18,495 Sq.ft



▲ **Union Co-op Mosque**  
Ground only  
Dubai Silicon Oasis, Dubai  
Design Proposal  
BUA: 11,574 Sq.ft



▶ **Jumeirah Mosque**  
G+M  
Jumeirah, Dubai  
Design Proposal  
BUA: 20,800 Sq.ft



▶ **Islamic Affairs**  
Ground only  
Lehbab First, Dubai  
Design + Supervision  
BUA: 7,864 Sq.ft







# Industrial Buildings



## Caterpillar Middle East

4 Nos. Workshops  
Industrial Factory G+M  
Office Building G+M  
Saih Shuaib Third, Dubai  
Design + Supervision  
BUA: 107,847 Sq.ft



## Gypsum Factory

Industrial + Office G+M  
Alquoz Industrial First, Dubai  
Design + Supervision  
BUA: 68,578 Sq.ft



## Capriole Industrial Warehouses

6 Nos. Warehouses  
Office Building G+1  
Saih Shuaib Fourth, Dubai  
Design + Supervision  
BUA: 89,678 Sq.ft





# BUS DEPOTS





# Bus Depots

RTA Al Ruwayya

Dubai  
Bus depots for 295 Buses  
Labor accommodations for 1,480 labors  
BUA: 178,492 Sq.ft

RTA Al Khawaneej

Dubai  
Bus depots for 242 Buses  
Service blocks  
BUA: 126,438 Sq.ft

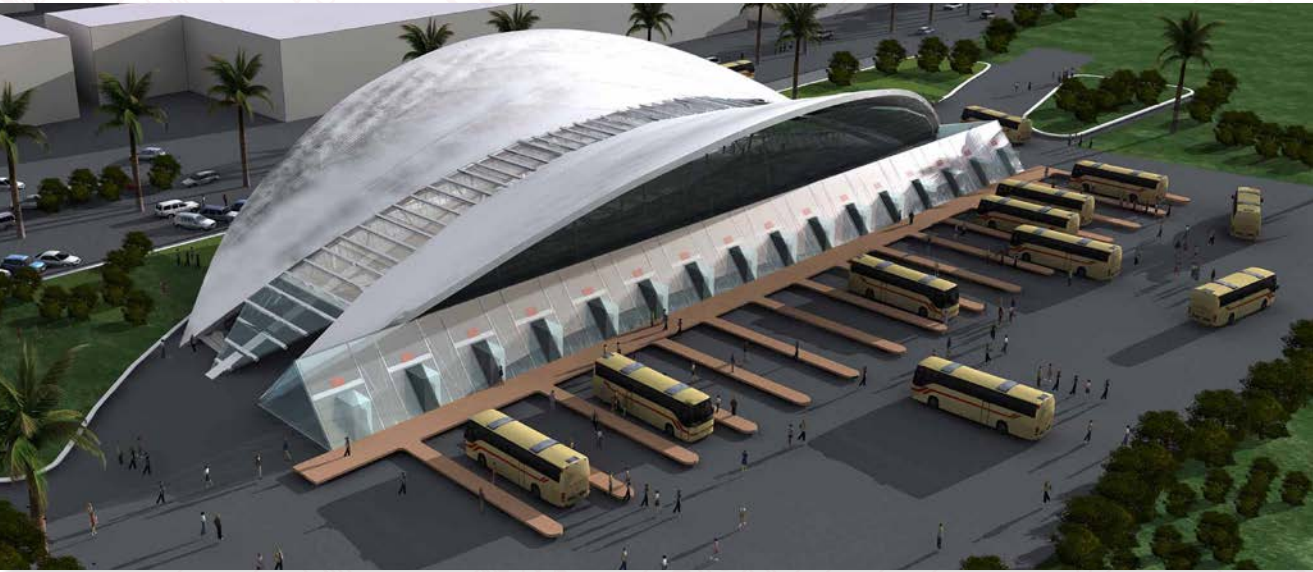

Abu Dhabi Bus Station

Proposal





## Certificate

Standard **BS OHSAS 18001:2007**  
 Certificate Registr. No. **01 113 106831**

Certificate Holder: **Pioneers of Experts Engineering Consultants,**  
 P.O. Box – 97046,  
 Dubai,  
 United Arab Emirates

Scope: **Provision of Architectural Design Consultancy and Project Supervision Services**

Proof has been furnished by means of an audit that the requirements of BS OHSAS 18001:2007 are met.

Validity: The certificate is valid from 2017-01-18 until 2019-12-19.  
 First certification 2010

2017-01-19

TÜV Rheinland Cert GmbH  
 Am Grauen Stein · 51105 Köln

 **DAKKS**  
 Deutsche  
 Akkreditierungsstelle  
 D-ZM 15031-01-00

 **TÜV Rheinland**  
 Precisely Right.

www.tuv.com

## Certificate

Standard **ISO 9001:2015**  
 Certificate Registr. No. **01 100 106831**

Certificate Holder: **Pioneers of Experts Engineering Consultants,**  
 Al Fattan Plaza Building, Office No. 711,  
 Al Garhoud, P.O. Box 97046, Dubai,  
 United Arab Emirates.

Scope: **Provision of Architectural Design Consultancy and Project Supervision Services.**

Proof has been furnished by means of an audit that the requirements of ISO 9001:2015 are met.

Validity: The certificate is valid from 2016-12-18 until 2019-12-19.

2018-09-22

TÜV Rheinland Cert GmbH  
 Am Grauen Stein · 51105 Köln

 **IAF**  **DAKKS**  
 Deutsche  
 Akkreditierungsstelle  
 D-ZM 15031-01-00

 **TÜV Rheinland**  
 Precisely Right.

www.tuv.com

## Certificate

Standard **ISO 14001:2015**  
 Certificate Registr. No. **01 104 106831**

Certificate Holder: **Pioneers of Experts Engineering Consultants,**  
 Al Fattan Plaza Building, Office No. 711,  
 Al Garhoud, P.O. Box 97046, Dubai,  
 United Arab Emirates.

Scope: **Provision of Architectural Design Consultancy and Project Supervision Services.**

Proof has been furnished by means of an audit that the requirements of ISO 14001:2015 are met.

Validity: The certificate is valid from 2016-12-18 until 2019-12-19.

2018-09-22

TÜV Rheinland Cert GmbH  
 Am Grauen Stein · 51105 Köln

 **IAF**  **DAKKS**  
 Deutsche  
 Akkreditierungsstelle  
 D-ZM 15031-01-00

 **TÜV Rheinland**  
 Precisely Right.

www.tuv.com



## OUR CLIENTS

